

USER MANUAL



Set up and operational instructions of the Holsim Intramuscular Block when mounted in the Interlocking Porcine.



Porcine Intramuscular Injection Model

Revision A:
Porcine Intramuscular
injection model

Product SKU:
P300-000

Last Updated:
25 September 2023



Parts List

Equipment Required:

- Interlocking Porcine Model (Preferably)
- Desk or Table (Alternative to Interlocking Model)
- Appropriate Needle for Injection
We recommend using a 1" or 1.5", 16-18 gauge needle for this model.

Set Up

1. Power Switch
2. Buzzer Switch
3. LED Light
4. Battery Compartment
5. Ear
6. Skin Layer
7. Subcutaneous Tissue Layer
8. Muscle Layer
9. Injection Area

For all parts or repairs, please contact Holsim through our website www.holsim.co.nz

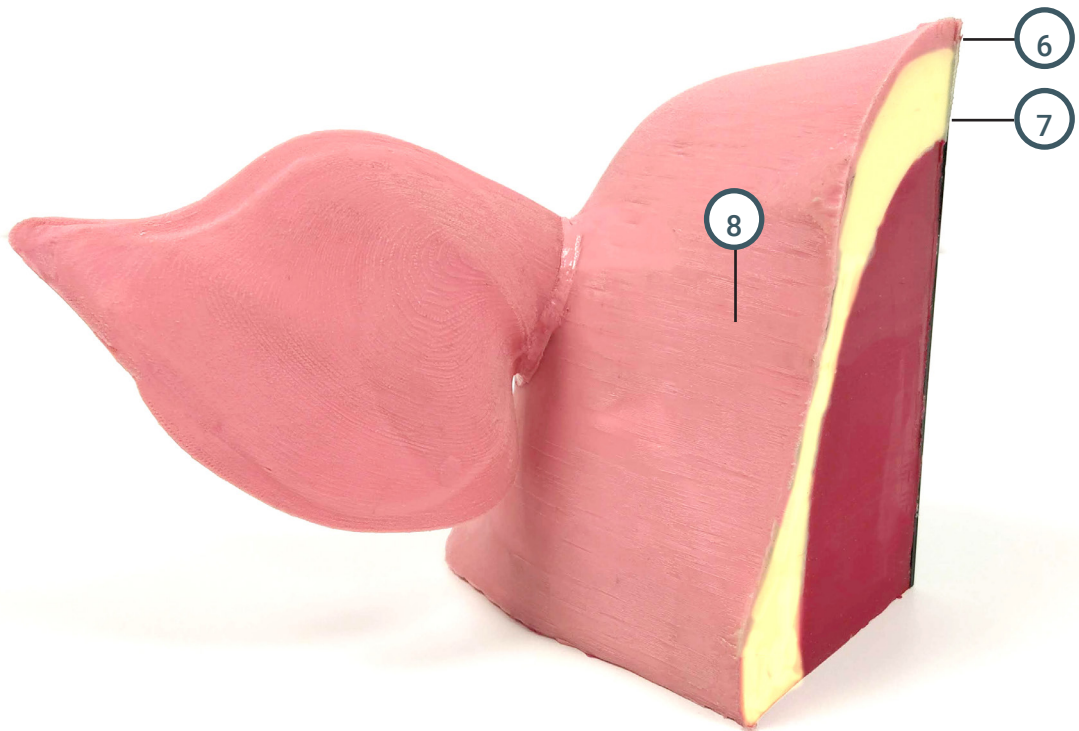
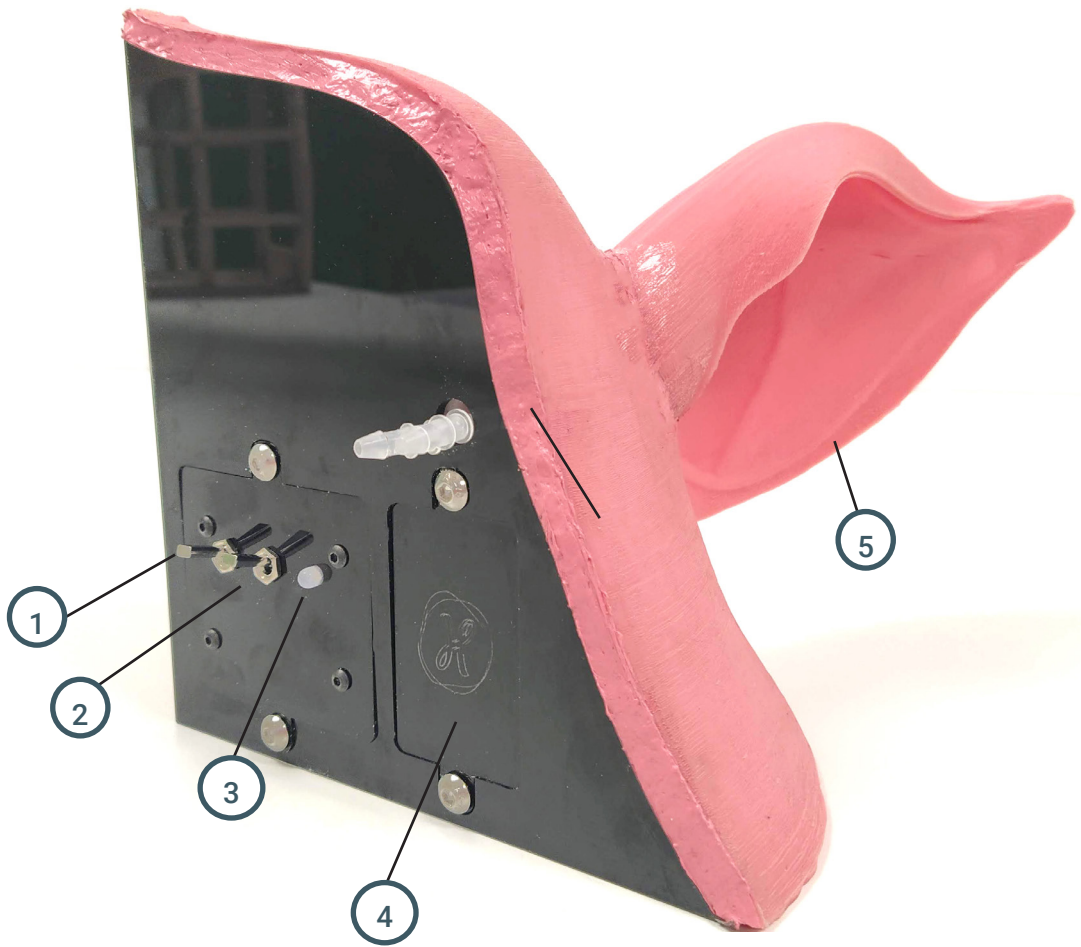



Set Up



1 Sit IM block into pig head

- Sit the Intramuscular Block (IM Block) onto the head of the pig as shown in photo.



2 Secure in place

- Align the hole in the plywood with the insert in the IM Block and screw in the knurl screw until tight.



3 Switch power on

- Turn the power on by flicking the left hand switch down. The LED light should turn on and glow red.



4 Switch buzzer on

- Turn the buzzer on by flicking down the right hand switch next to the power switch.
- Note: If you would like to challenge your students more, leave the buzzer off until the student believes their needle is in the correct position of injection. Then switch the buzzer on and see if it sounds.

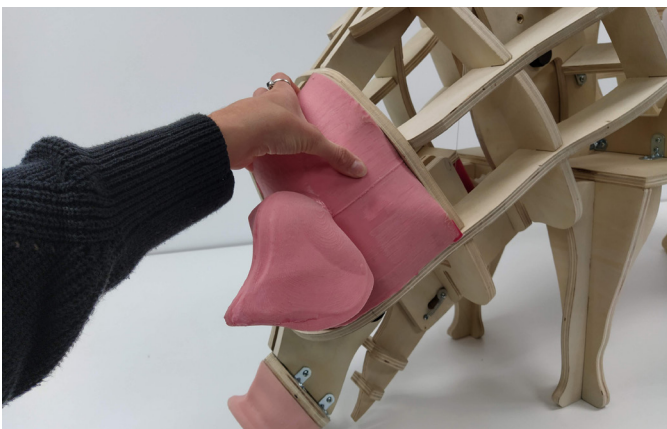

5 Palpate injection area

- Palpate the area for injection. This should be up to 70mm behind the ear and just below the ear, in front of the shoulder.

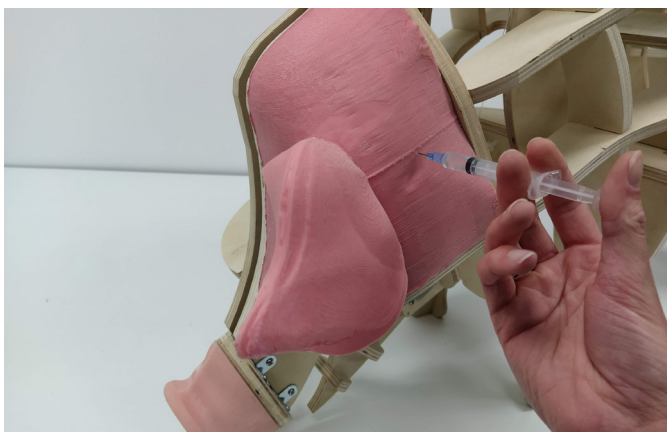

6 Insert needle at 90 degrees

- Insert the needle at 90 degrees, pushing through the skin and past the subcutaneous tissue layer, into the muscle.
- If the correct place it reached, the buzzer will sound and the LED will change from red to green.



The Battery Replacement

Equipment Required:

- Porcine Intramuscular Injection Model
- 1x 9V Battery
- Allen Key

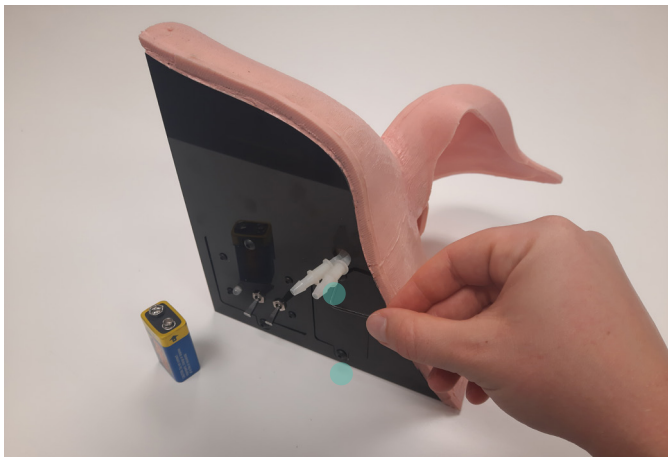

8 Undo the 2 outer screws

- Undo the 2 screws indicated

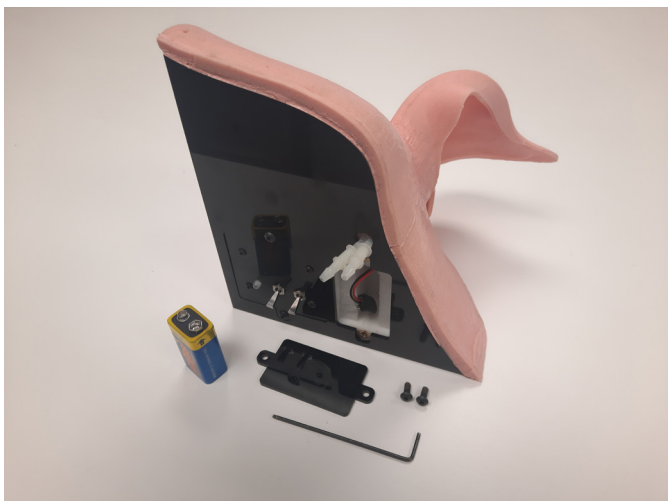

9 Open acrylic battery cover

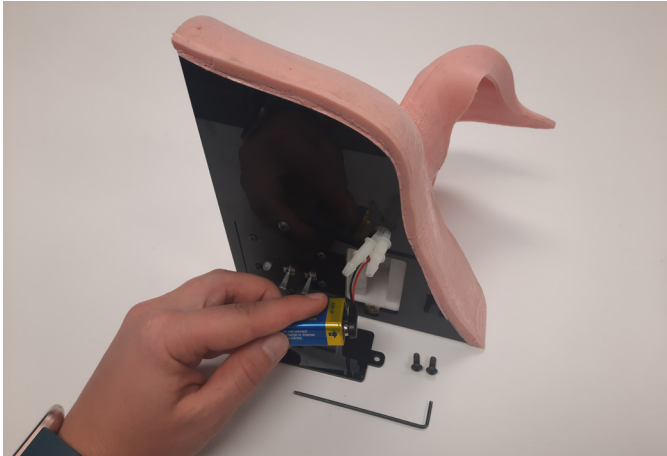

10 Attach battery

- clip battery to terminal

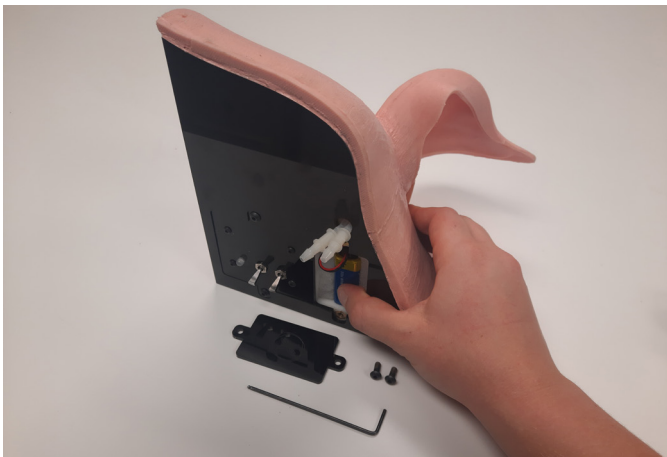

11 located battery

- Place battery between foam padding

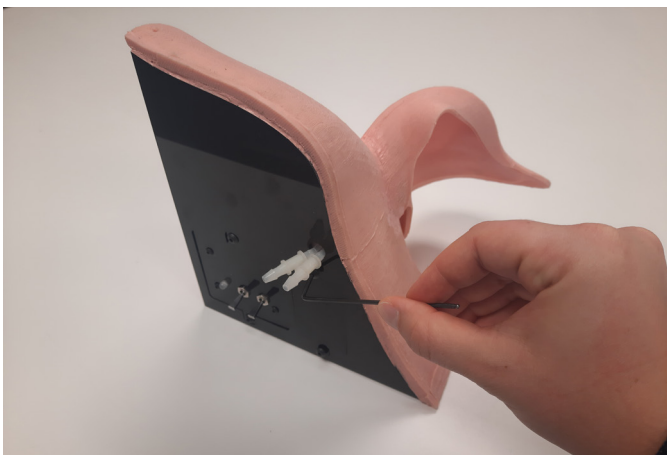

12 Close acrylic battery cover and tighten screws

Holsim

34D Somerset
Street, Hamilton,
New Zealand, 3204



07 839 5018



info@holsim.co.nz